

# RO-50

1 PORTA  
1 DOOR  
1 PUERTA  
1 PORTE

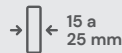

COMPONENTES/ COMPONENTS/ COMPONENTES/ COMPOSANTS

Inclusos no Kit/ Included in the Kit/ Incluidos en el Kit/ Inclus dans le Kit

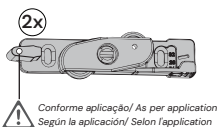
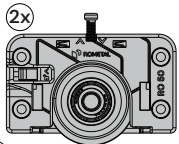

Recomendados/ Recommended/ Recomendados/ Reconnmés



**3,5 x 14 CC**  
Carros inferiores  
Bottom carriages  
Carros inferiores  
Chariots inférieures

**3,5 x 22 CC**  
Guias e freios  
Guides and brakes  
Guías y frenos  
Guides et freins

Opcionais/ Optional/ Opcionales/ Optionnels

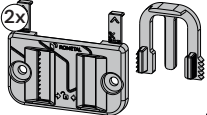

**Dispositivo antidescarrilamento**  
Anti-derailment device  
Dispositivo antidescarrilamento  
Dispositif anti-déraillement

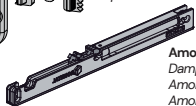

**Amortecedor Comfort 240**  
Damper Comfort 240  
Amortiguador Comfort 240  
Amortisseur Comfort 240

CÁLCULO DA PORTA/ DOOR CALCULATION  
CÁLCULO DE LA PUERTA/ CALCUL DE LA PORTE

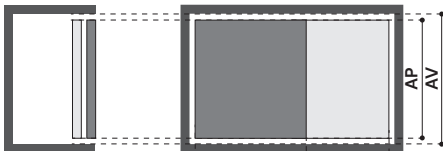

**AP= AV-35 mm**

**Altura da porta (AP)**  
Door height  
Altura de la puerta  
Hauteur de la porte

**Altura do vão (AV)**  
Opening height  
Altura del vano  
Hauteur de l'ouverture



**20 a 30 mm**  
Transpasse indicado  
Recommended overlap  
Solape recomendado  
Recouvrement recommandé

INSTALAÇÃO/ INSTALLATION/ INSTALACIÓN/ INSTALLATION

1 Furações/ Drillings/ Perforaciones/ Perçages

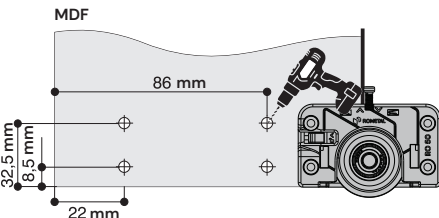

Alumínio/ Aluminium/ Aluminio/ Aluminium

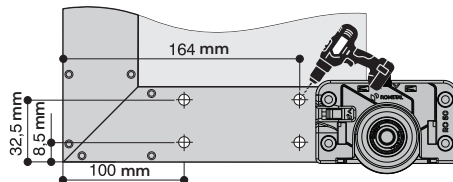

2 Instale os guias/ Install the guides  
Instale las guías/ Instalez les guides

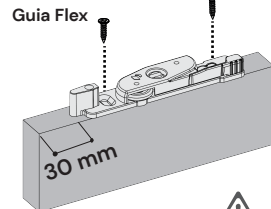

Centralize o guia na porta  
Center the guide on the door  
Centre la guía en la puerta  
Centrez le guide sur la porte



**Opções de guias**  
Guide options  
Opciones de guías  
Options de guides



**Amortecedor Comfort 240**  
Damper Comfort 240  
Amortiguador Comfort 240  
Amortisseur Comfort 240

Espaçamento do trilho/ Track spacing  
Espaciado del riel/ Espacement du rail

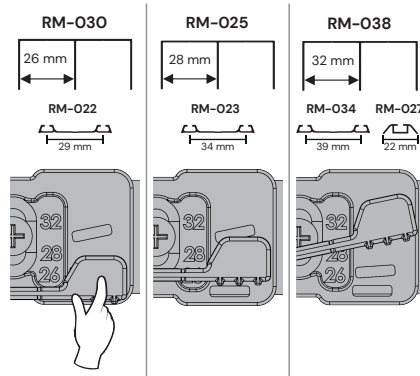

3 Fixe o antidescarrilamento  
Secure the anti-derailment device  
Fije el dispositivo de antidescarrilamento  
Fixez le dispositif anti-déraillement

Com guia  
With guide  
Con guía  
Avec guide



**3,5 x 12 CC**  
Parafusos inclusos no kit  
Screws included in the kit  
Tornillos incluidos en el kit  
Vis incluses dans le kit

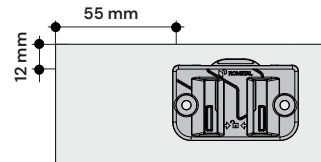

- 4 Destaque os posicionadores**  
Remove the positioning guides  
Retire los posicionadores  
Retirez les positionneurs

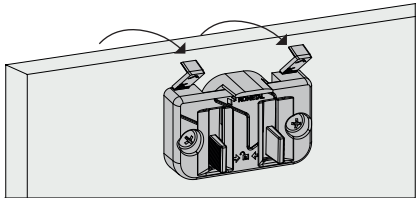

- 5 Instale os trilhos/ Install the tracks**  
Fije los rieles/ Installez les rails

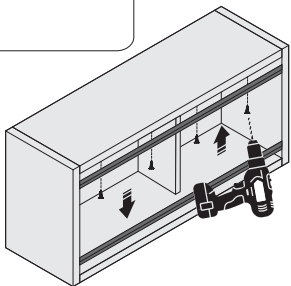
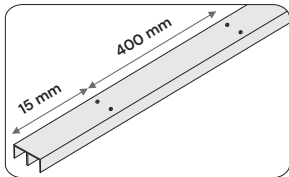

- 6 Fixe o freio no trilho superior**  
Attach the brake to the top track  
Fije el freno en el riel superior  
Fixez le frein sur le rail supérieur

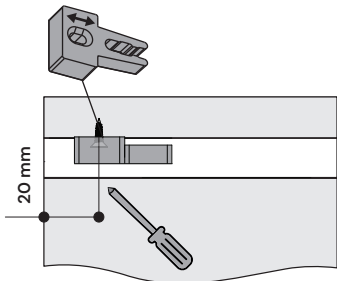

- 7 Encaixe as portas/ Fit the doors**  
Encaje las puertas / Insérez les portes

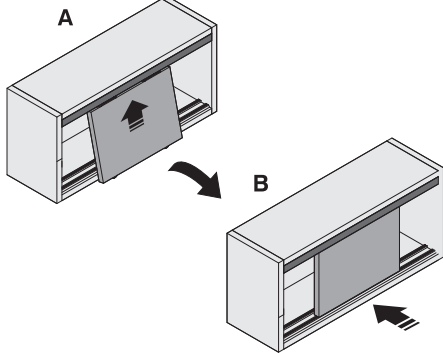

- 8 Regule as portas**  
Adjust the doors  
Ajuste las puertas  
Ajustez les portes

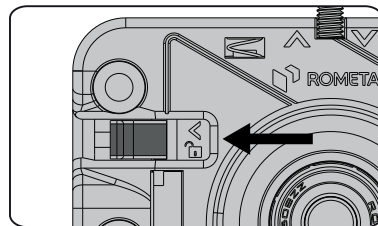

**Destrave as molas**  
Unlock the springs  
Desbloquee los muelles  
Déverrouillez les ressorts

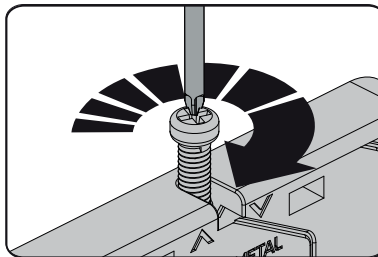

**Regule a altura da porta**  
Adjust the door height  
Ajuste de la altura de la puerta  
Réglez la hauteur de la porte

- 9 Regule o antidescarrilamento**  
Adjust the anti-derailment device  
Ajuste el dispositivo de antidescarrilamiento  
Réglez le dispositif anti-déraillement

